

A/C – GENERAL INFORMATION

The following A/C equipment is installed in the house: three types of A/C Units – **Concealed Fan Coil Unit¹**, **Wall-Mounted Unit²**, **Hepvo Trap³**, **Master Control Panel⁴**, **Remote Controller⁵** and **Condenser Units^{6, 7, 8}**.

Please note: Air Conditioning Unit is also known as FCU (Fan Coil Unit) or VRF (Variable Refrigerant Flow), especially in technical drawings.

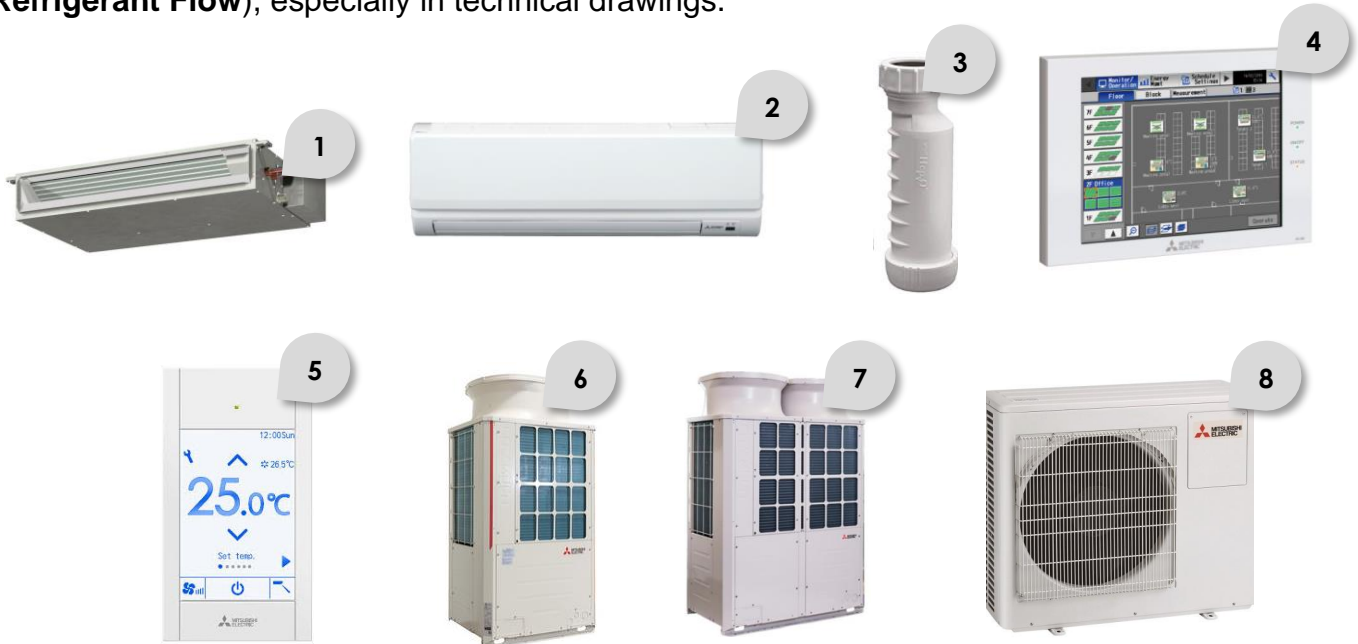

All A/C Units have their **Controller⁵** fitted inside the nearby cupboard or mounted on the wall in that particular area. There is also a **Spur Switch** either clearly visible in the areas with wall mounted units or in case of concealed units the **Spur** is fitted next to them. There is a **Hepvo trap** leading away condensate fluid and a **Grille** serving the corresponding room. All **Condensers^{6, 7, 8}** are located outside.

For more information on the operation of the **Master Control Panel** please refer to the following page.

For more information on the operation of the **Remote Controller** please refer to the following pages.

For more information on location of each **A/C Unit** and the **Condensers**, please refer to the following pages.

A/C installed and maintained by – Blurred for Privacy Reasons

A/C – GENERAL INFORMATION (Cont.)

MASTER CONTROL PANEL

There is also a **Master Control Panel** located in the **Main Plant Room (B)**. This can control all the A/C Units.

To switch off the **Mitsubishi Control Panel** completely, shut the **Breaker No. 1 / L1** labelled "**Mitsubishi Control Panel**" on the **Distribution Board "DB MECH"**² in the **Main Plant Room (B)**.

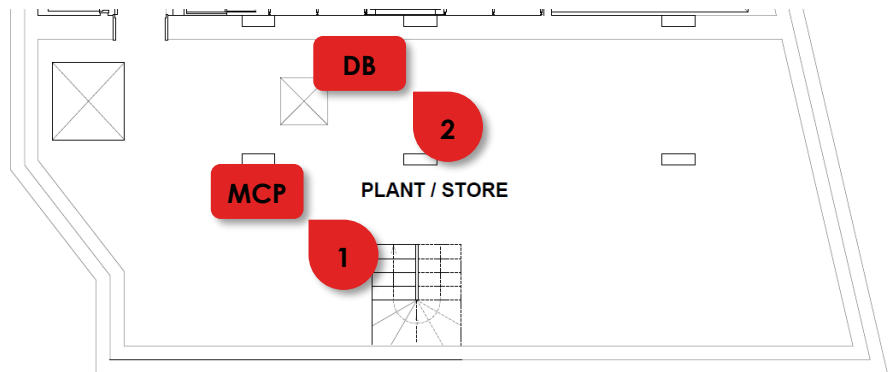

REMOVING THE ACCESS PANELS

Some A/C Units are located behind **Access Panels**¹. To remove the access panels, you should use a **T-key**² or a **Flat Screwdriver**³. Simply putting this key into the holes³ of access panels and turning will unlock it and enable the panel to swing open. Be sure to hold the panel while opening the last lock. Then carefully put the panel aside on a mat or soft cloth to avoid scratching the floor. Depending on the height of the ceilings on a particular floor, a **Step Ladder**⁴ of varying heights will be required for easy access to the panels and especially the units themselves.

