

PASSENGER LIFT

The **Passenger Lift**¹ goes through all five floors – from **Basement** up to the **Second Floor**.

Its **Motor**² and **Main Isolator Switch**³ are located in the **Service Corridor (B)**.

To switch off the **Passenger Lift** completely, shut the **Breaker No. 7** labelled “**Main Supply Passenger Lift**” on the **Main Distribution Board “DB MP”**⁴ in the **Small Plant Room (LGF)**.

SERVICE CORRIDOR (B)

SMALL PLANT ROOM (LGF)



In case of emergency, dial the number 0208 654 6938. It will automatically connect you to the central control station dedicated to the lift in this house.

For any other reasons, when the maintenance is needed, please contact **Swallow Lifts Ltd** – contact details are provided below.

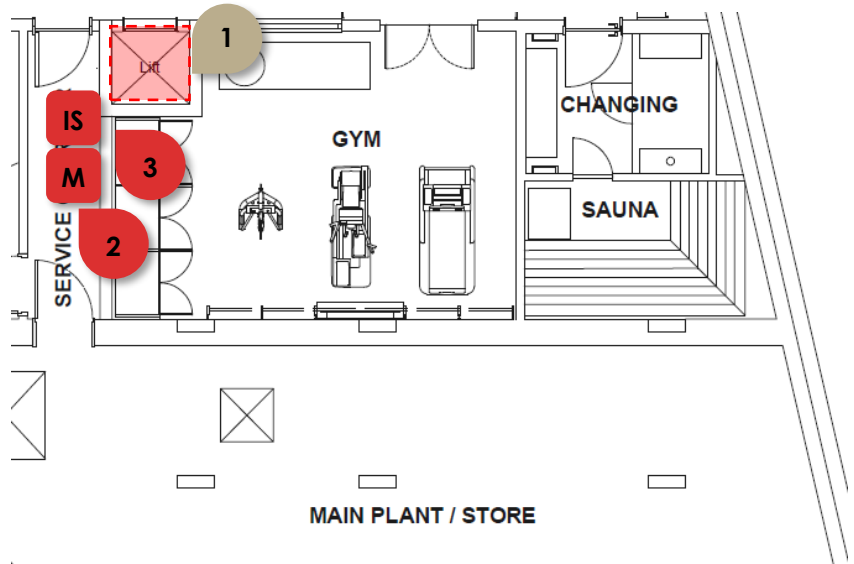

Passenger Lift supplied and maintained by – Blurred for Privacy Reasons

Swallow
Units
London
SE20

SWALLOW
LIFTS

PASSENGER LIFT (Cont.)

PASSENGERS TRAPPED IN A LIFT

Should a passenger be trapped in the cabin, the user must follow a series of preventative measures for their own way.

- If the lift stops but the doors do not open, press the open button. If nothing happens, press the alarm button to obtain aid from the relevant personnel.
- Do not try to exit the lift without help from qualified personnel; when the lift stops irregularly, do not force the doors.
- Keep calm; do not repeatedly press the button or command panel. Repeat. If it does not work, press the alarm button and wait to be rescued.
- Breathe normally: ventilation in the cabin is guaranteed.

UNIT FEATURES

- Lift Cabin¹
- Call Button²
- Cabin Push Buttons³

